

Maternelle 3

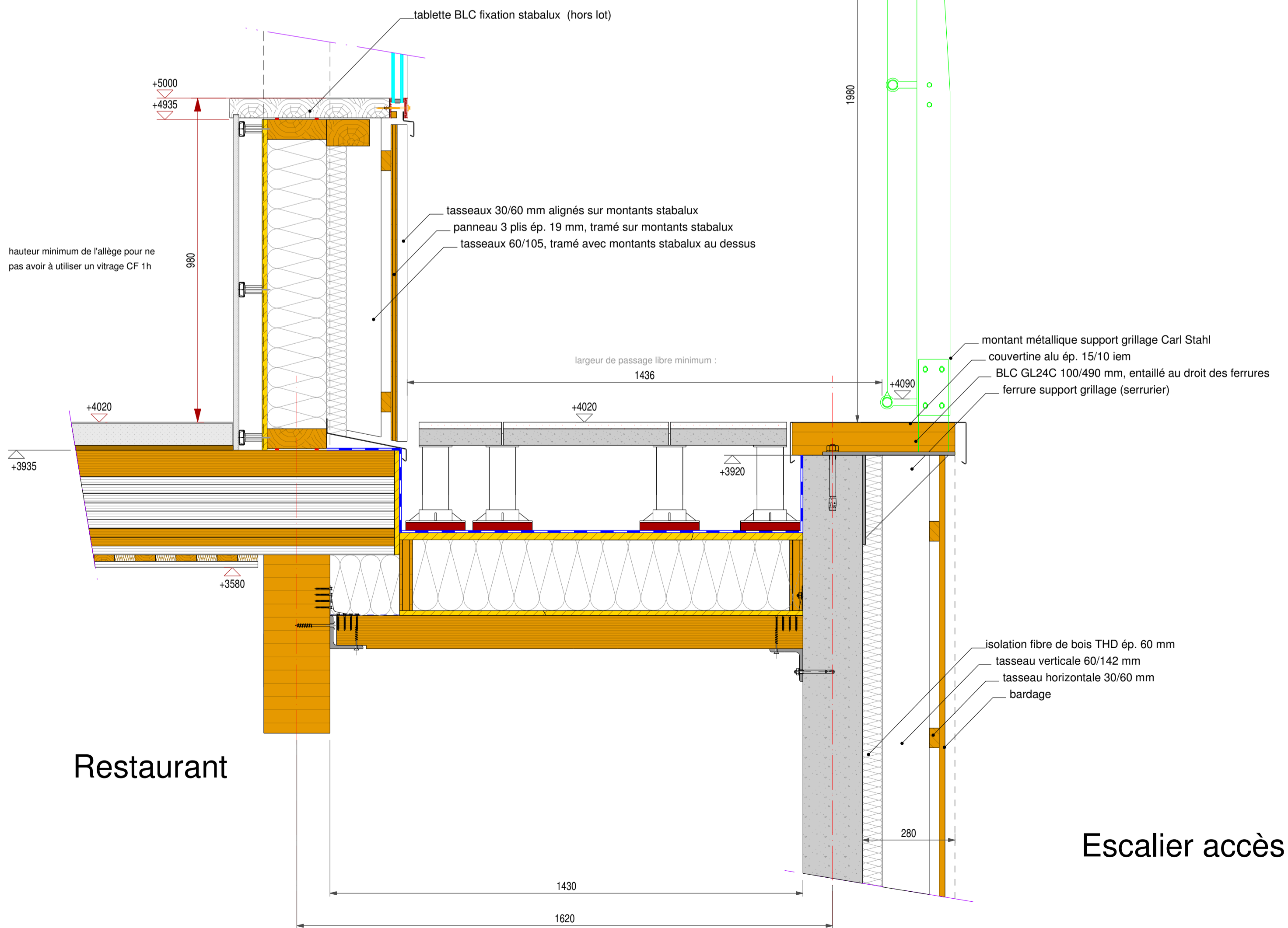













Restaurant

Escalier accès M3

Coupe Re-2

Plan de toiture

LEGENDE

-  Bardage texturé mélèze
-  Isolation fibre de bois haute densité ép. 60 mm
-  Montant ossature 60x180 + isolation fibre de bois ép. 180 mm
-  Montant ossature 60x100 + isolation fibre de bois ép. 100 mm
-  Panneau fermablel contreventant
-  Panneau OSB
-  Plaque de plâtre
-  Mur béton
-  Chevron BM
-  Poutre métallique
-  Poutre BLC
-  Contreventement diagonale BLC
-  Contreventement tendeurs halien-déha
-  Poteau métallique
-  Poteau BLC
-  Poteau béton
-  Emprise local technique 4
-  Sens de pente de la toiture

Toiture du RdC

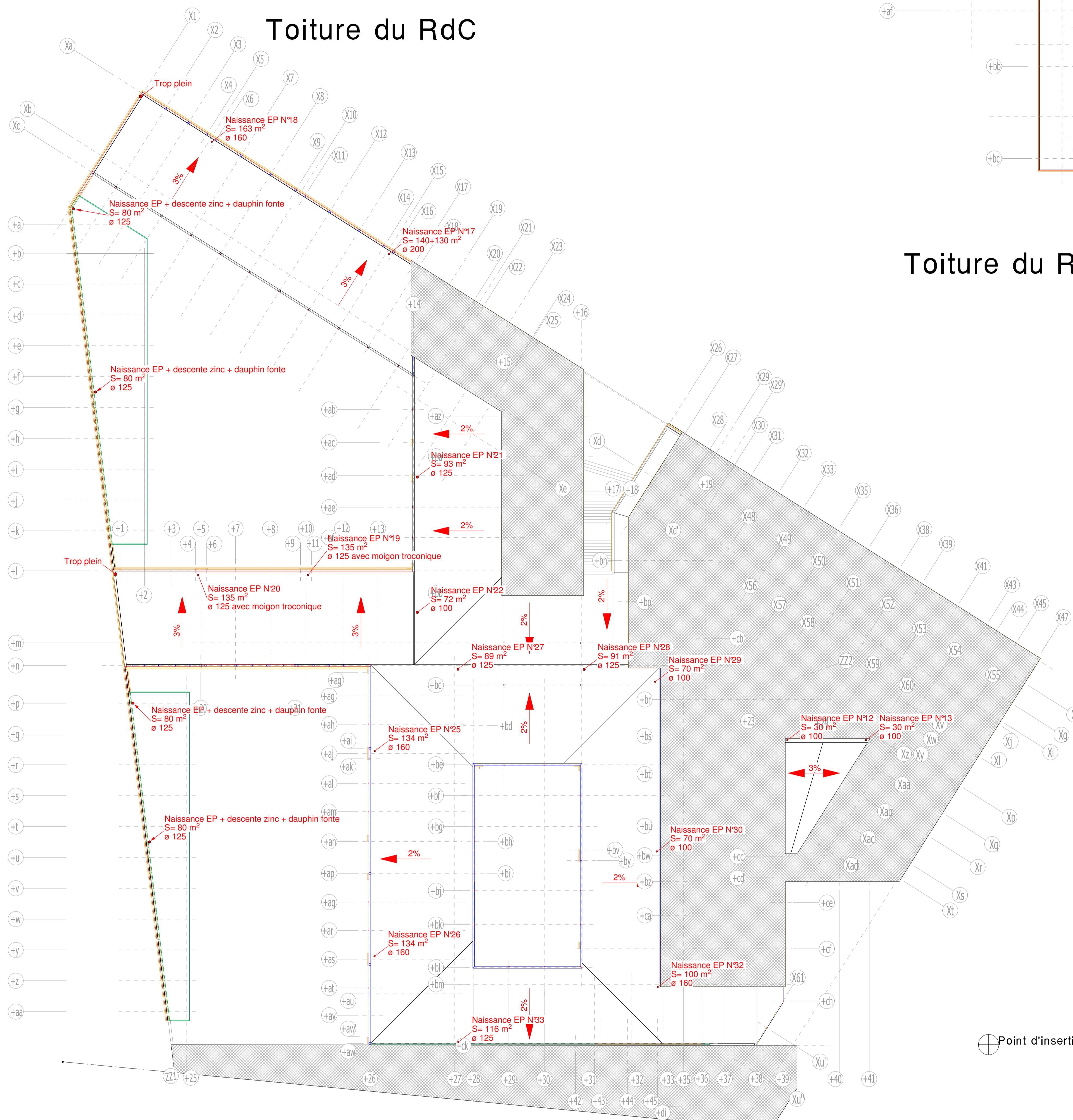

Toiture du R+1

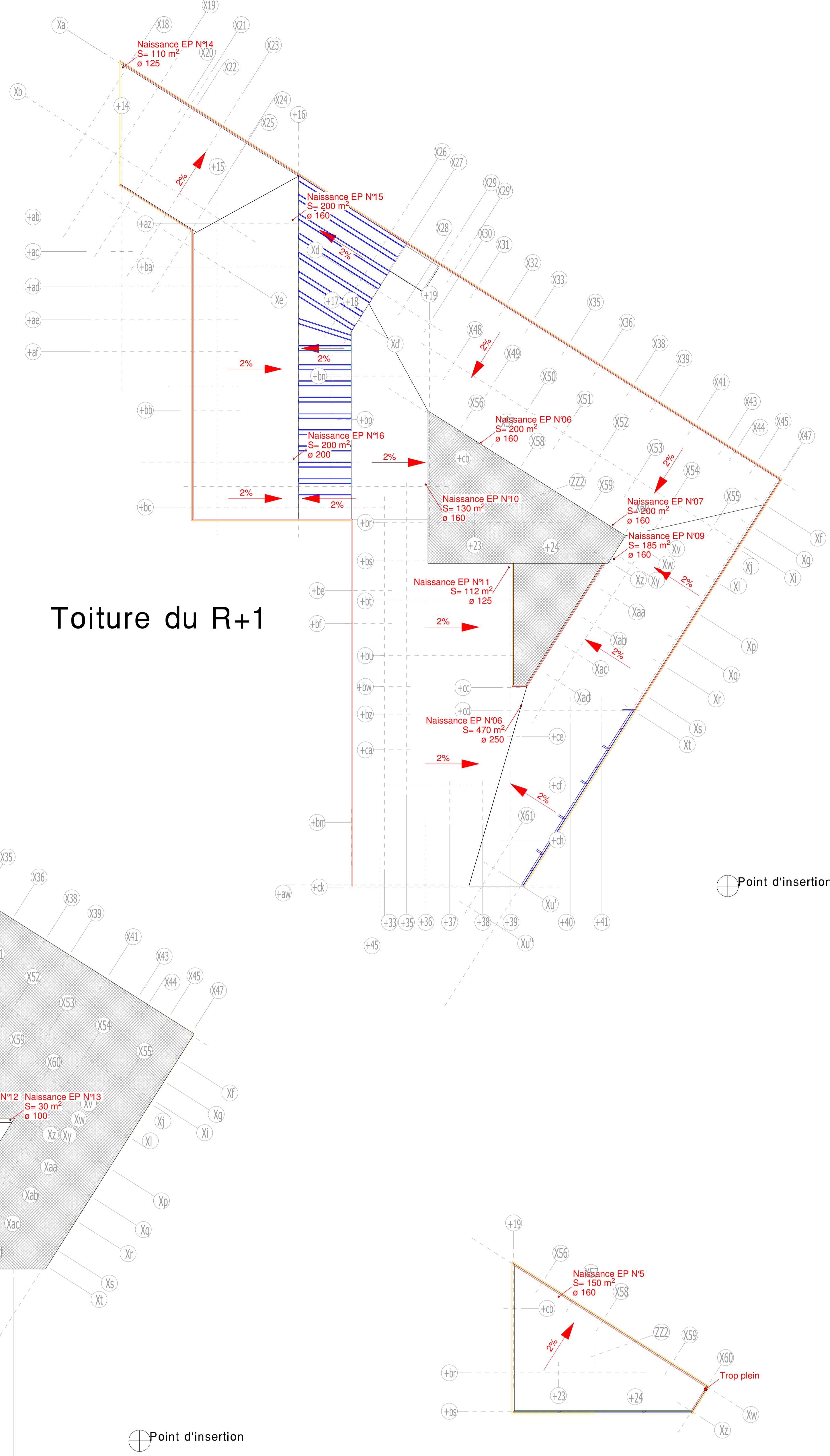

Toiture du R+2

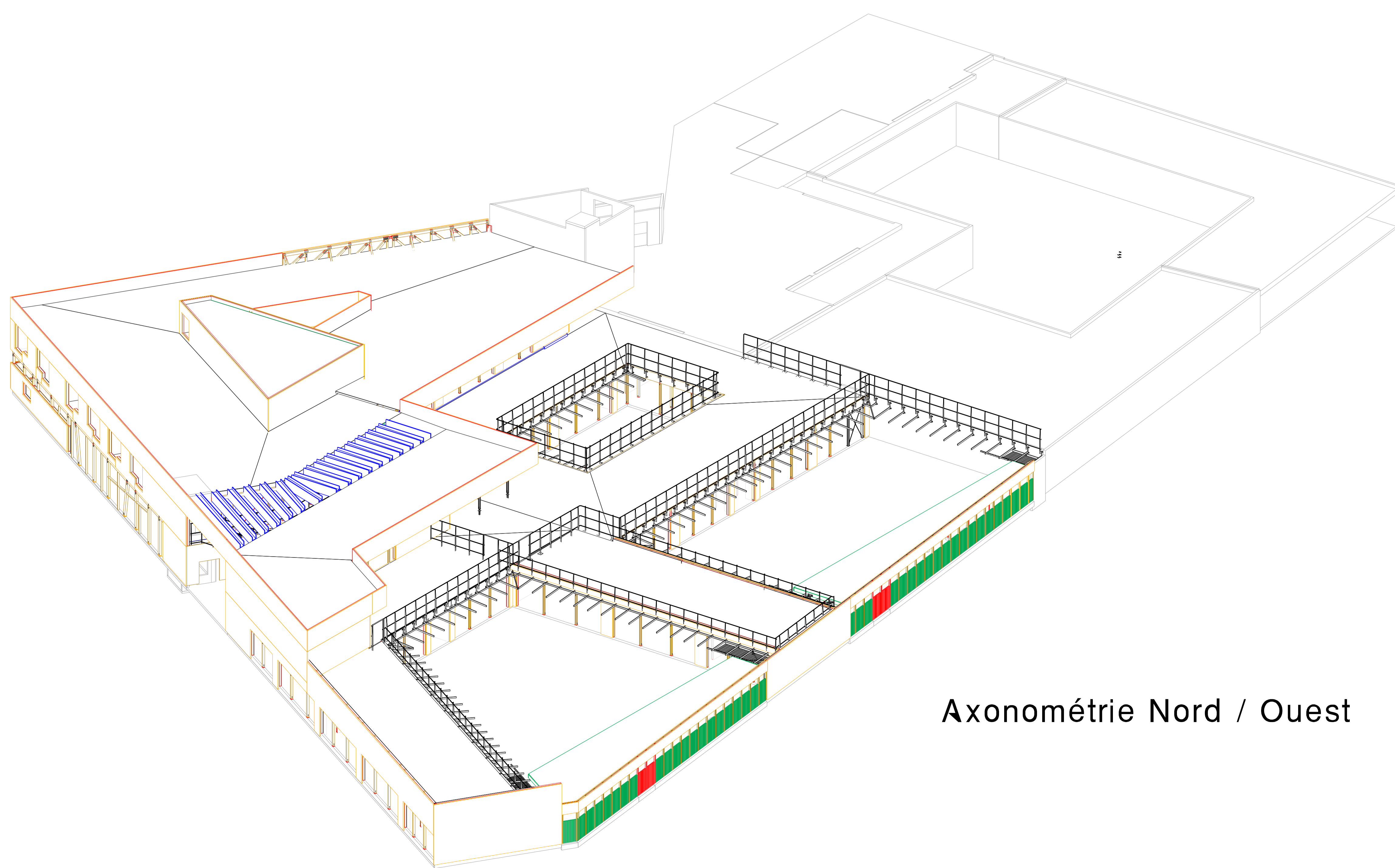
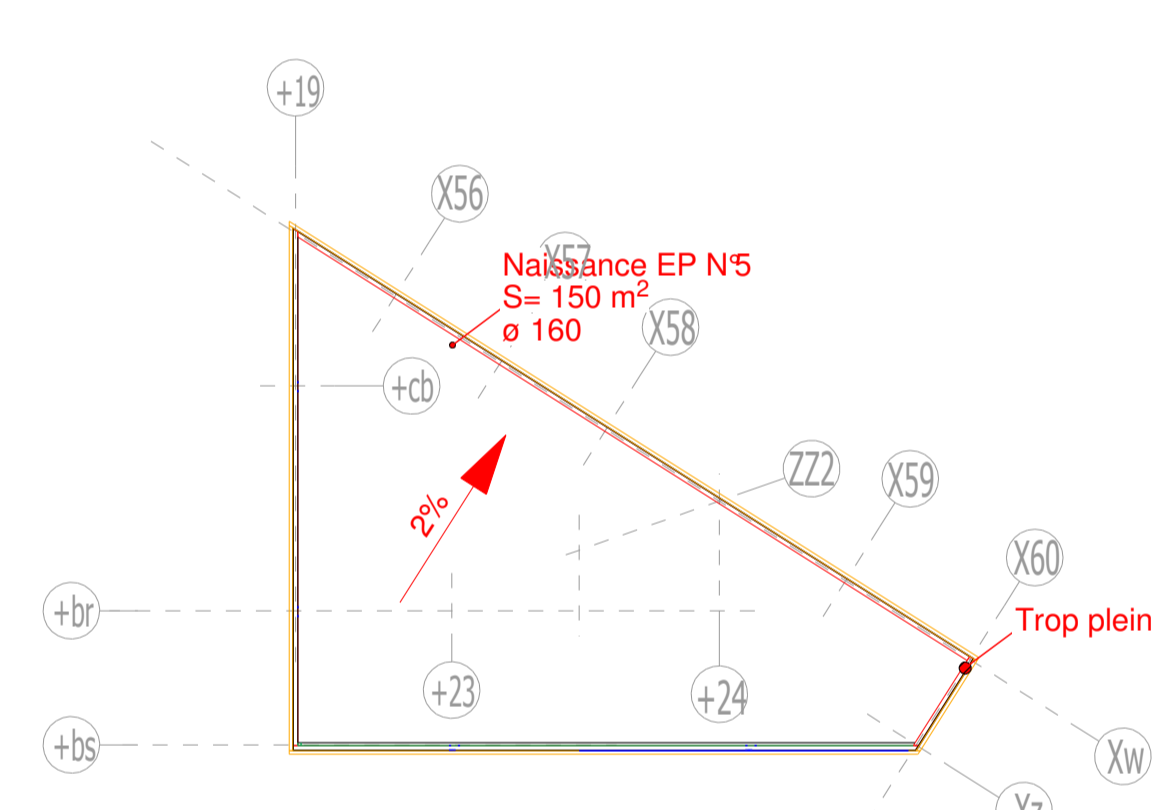

Axonométrie Nord / Ouest

- LEGENDE**
- Bardage texturé mélèze
 - Isolation fibre de bois haute densité ép. 60 mm
 - ▨ Montant ossature 60/180 + isolation fibre de bois ép. 180 mm
 - ▨ Montant ossature 60/100 ou 60/120 + isolation fibre de bois ép. 100 ou 120 mm
 - Mur béton
 - Panneau fermececi contreventant
 - Panneau OSB
 - Plaque de plâtre
 - Poteaux métallique
 - Poteaux BLC GL 24 c
 - Poteaux BLC GL 28 h
 - Poteaux béton
 - Contreventement diagonale BLC
 - Contreventement tendeurs haffen

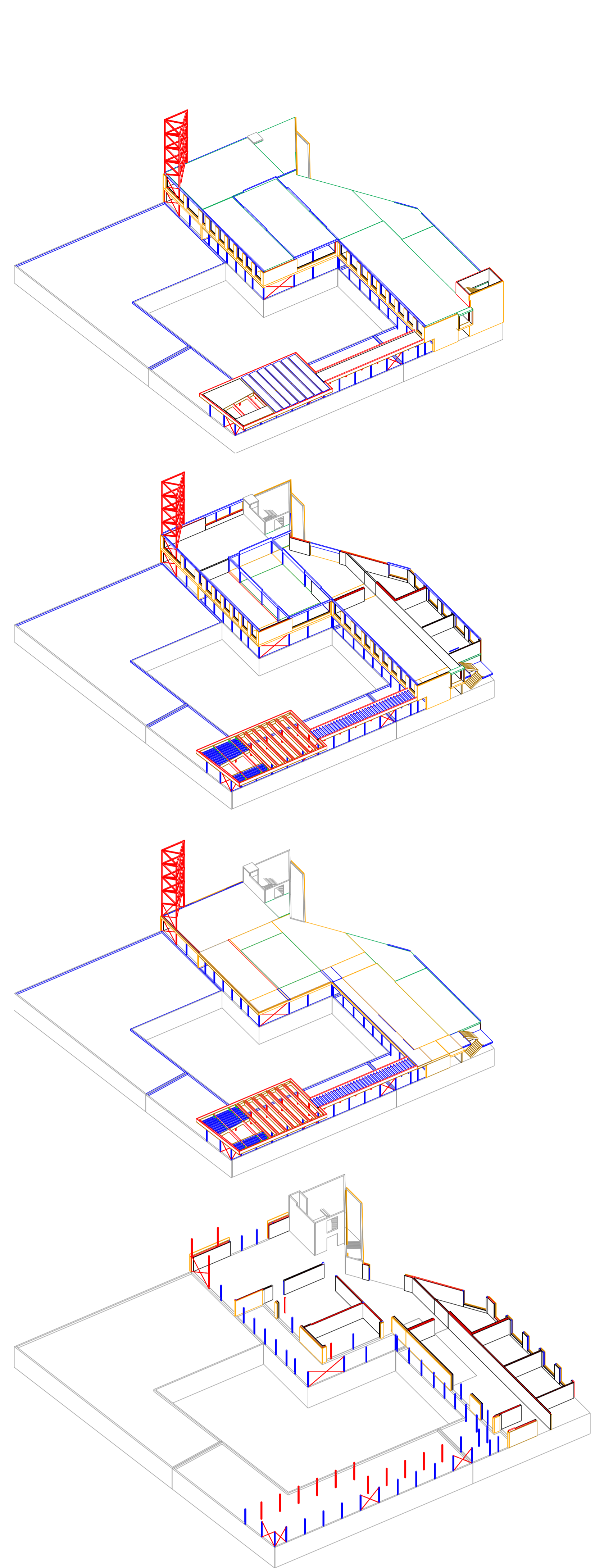

Axonométrie Sud / Ouest

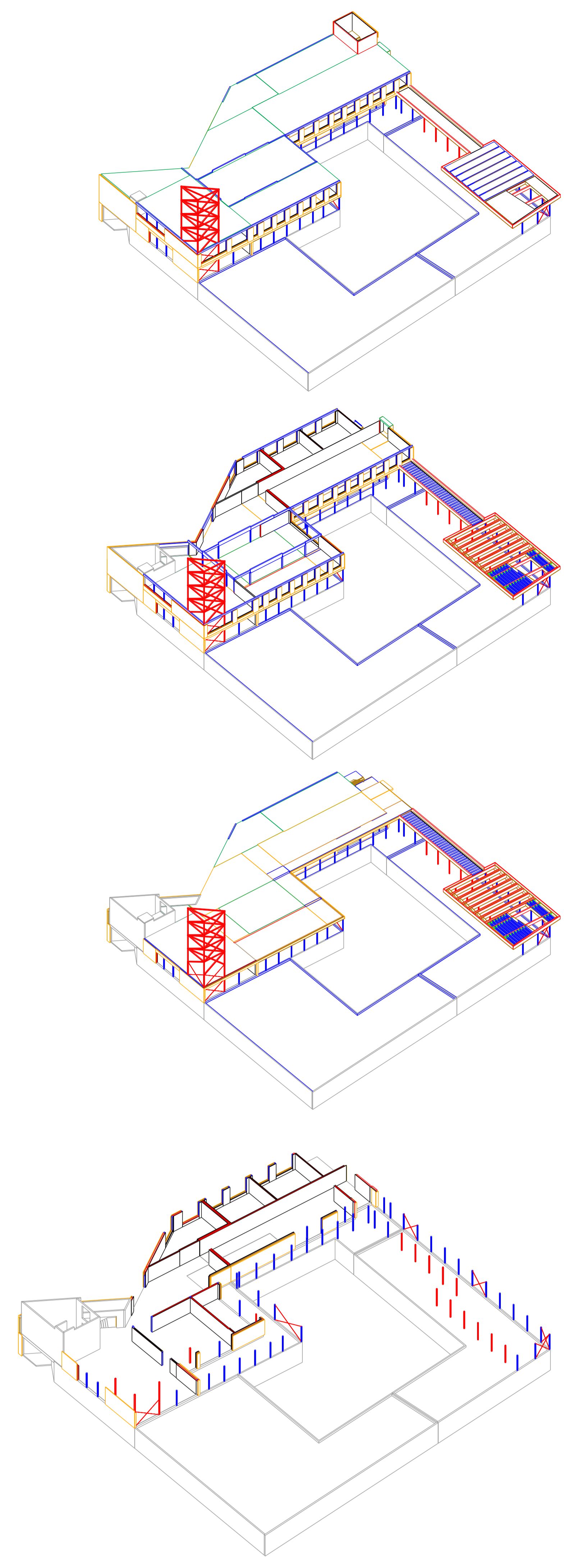

Axonométrie Nord / Ouest

Toiture

Structure bois R+2

Plancher R+2

Structure bois R+1

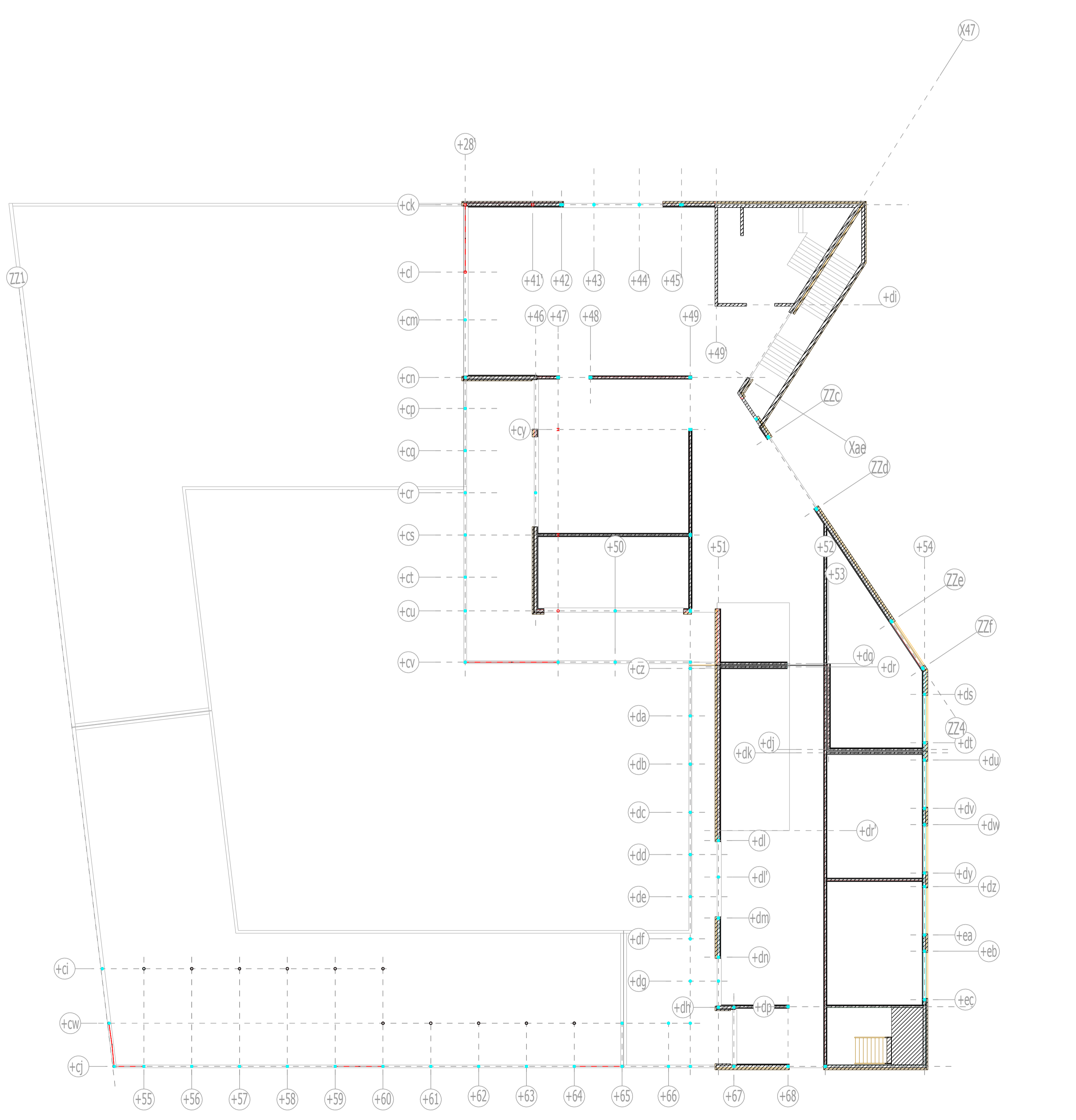

Plan d'implantation des poteaux et parois structurales du R+1

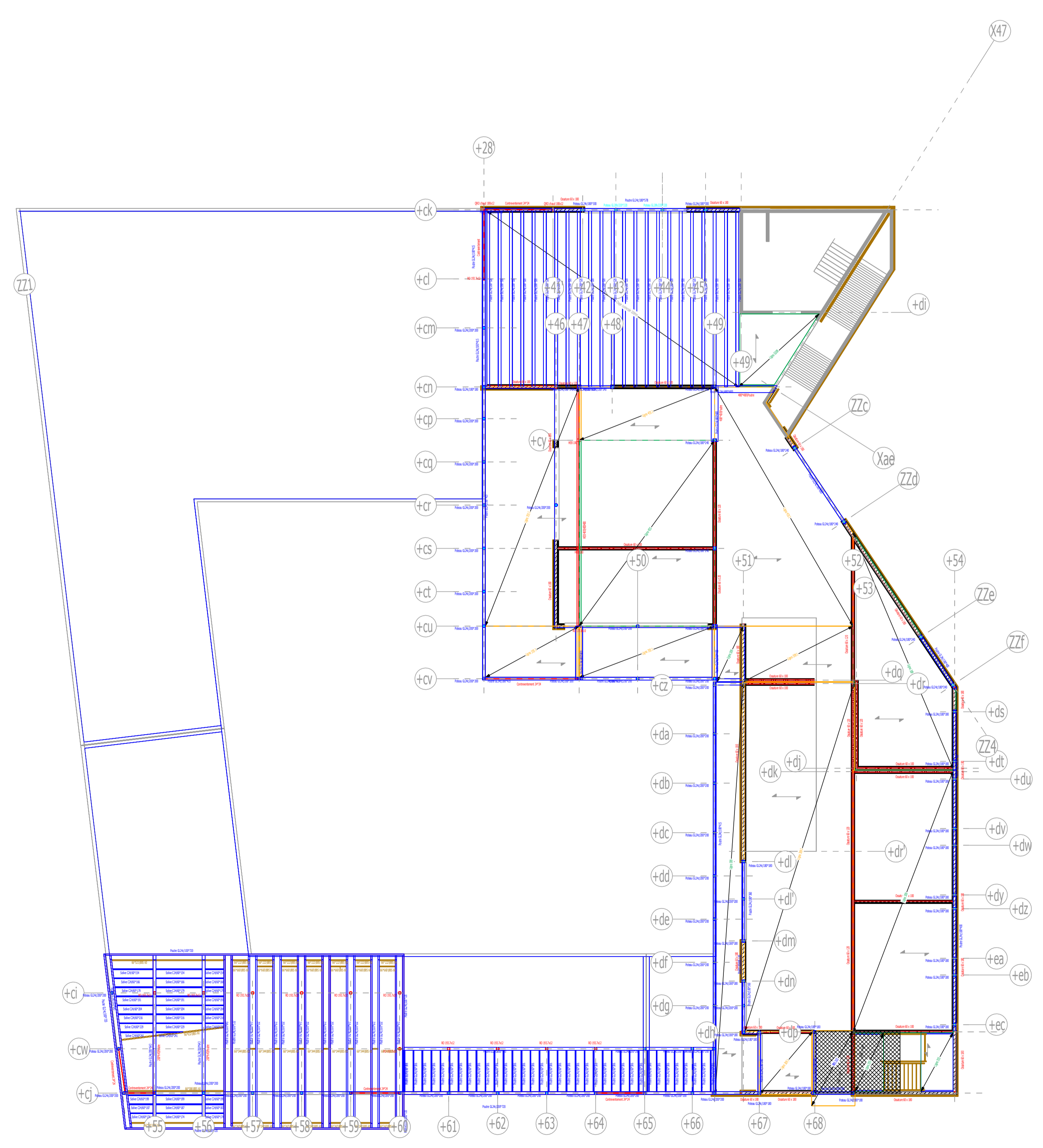

Plan d'implantation des planchers et leurs poutres porteuses